

Welcome to Litholink. Litholink is a laboratory that specializes in 24-hour urine testing for kidney stone formers. Your provider has requested that you complete a Litholink At-Home kit. Your provider is waiting on these test results in order to start your kidney stone treatment plan.

Please make sure to read the instructions and verify your supplies before starting your At-Home kit.  
Important Reminders:

- If you were given a test request form/lab order for your Litholink At-Home kit, you will need to return it in the box with your completed urine samples. Failure to return this form may result in your samples being rejected and having to repeat the entire process again. If your provider faxed the test request form or lab order directly to Litholink we will have it on file.
- Your collection must be at least 22 hours long, but no longer than 26 hours.
- You must collect all of your urine for 24 hours.
- Do not refrigerate your urine.
- The preservative (the liquid, uncapped bottle, and cap) must be dropped into the large orange jug at the start of your collection
- Do not let stool contaminate your urine collection
- Stop taking Vitamin C (pill form, vitamins, and/or supplements) that is greater than 100 mg per day 5 days prior to the start of your At-Home kit. Vitamin C occurring in foods and drinks can be ingested as normal.
- Your sample is extremely time sensitive; you must ship your sample(s) the same or next business day (Mon-Sat). Any sample received after 96 hours from the start of the collection will be rejected.

For more information, FAQs or to contact us visit [www.Litholink.com](http://www.Litholink.com) or email at [LitholinkInquiry@labcorp.com](mailto:LitholinkInquiry@labcorp.com)

**Verify that you have received all necessary collection materials. Keep the Patient Sample Shipping Box; it will be used for returning your samples.**



- 1 collection container per specimen



- 1 green-topped 50 ml tube per specimen



- 1 tube of liquid urine preservative per specimen



- 1 biohazard bag with absorbent paper

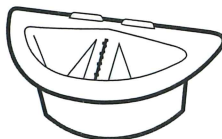

- 1 Collection Aid Included for females

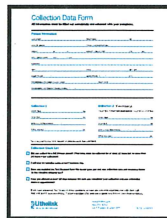

- Forms  
• Collection Data Form  
• Insurance Information Form

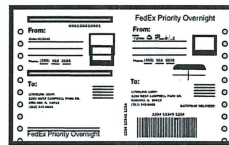

- 1 pre-paid FedEx mailing form



- 1 Litholink Patient Sample Shipping Box

# Collection Instructions

Do not record any information on this sheet, please use the *Collection Data form*.

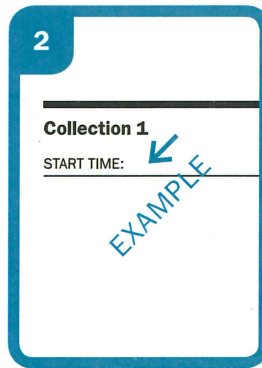
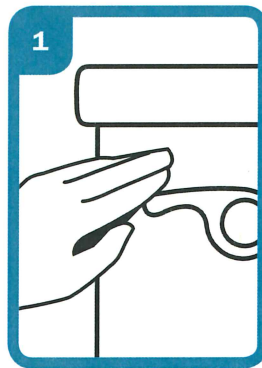
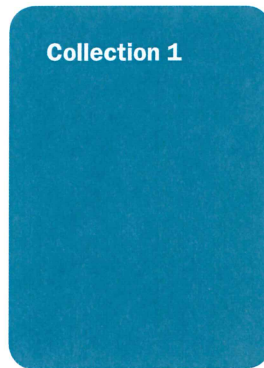

Helpful Hint: Schedule your Fed-Ex pick-up for the day you plan to finish your collection(s). See shipping Instructions #6.

When you wake up in the morning, flush your first urine in the toilet. **This is the START TIME.**

Record this time on the *Collection Data Form* where it says **START TIME**.

Open the tube of urine preservative and empty it into the collection container. Handle preservative with care and keep out of reach of children.

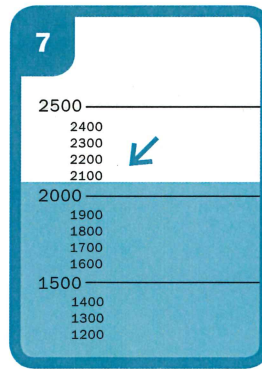
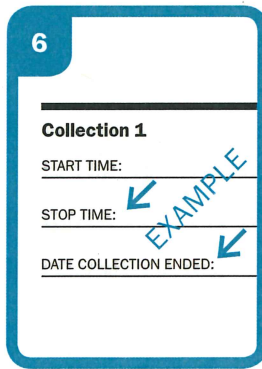
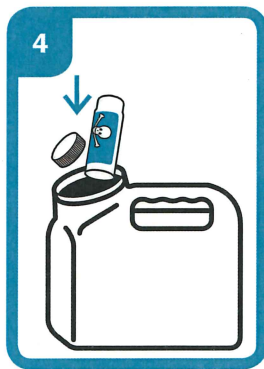

Drop the **urine preservative tube and lid** into the collection container. This ensures every drop of the preservative gets into the container.  
\*Do not place urine in the refrigerator at any time.

Collect all of your urine into the container over the next 24 hours, **including any urine collected during the night and that first urine of the following morning.** **This is the STOP TIME.** For women who may have trouble urinating directly into the collection container, place the collection aid over the toilet and then pour the urine into the collection container.

Record the **STOP TIME** on the *Collection Data Form* where it says **STOP TIME**.  
Record the date you finished the collection on the *Collection Data Form* where it says "DATE COLLECTION ENDED".

Place the collection container on a flat surface and use the measuring tool along the side of the container to read how much fluid is inside the container. **This is the TOTAL VOLUME.**

# Collection Instructions *(continued)*

**8**

**Collection 1**

START TIME: \_\_\_\_\_

STOP TIME: \_\_\_\_\_

DATE COLLECTION ENDED: \_\_\_\_\_

TOTAL VOLUME: *EXAMPLE* \_\_\_\_\_

Record this TOTAL VOLUME on the *Collection Data* form where it says "TOTAL VOLUME".



Secure lid and shake the collection container.

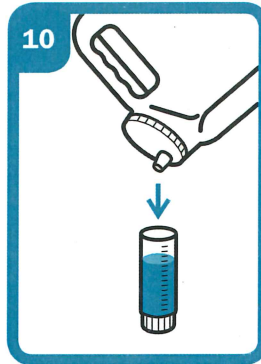

Fill the green-topped tube marked Collection 1 about 3/4 full with the urine sample.

*If you have been instructed to do two 24-hour collections, fill the second green-topped tube marked Collection 2 about 3/4 full from the second collection container.*

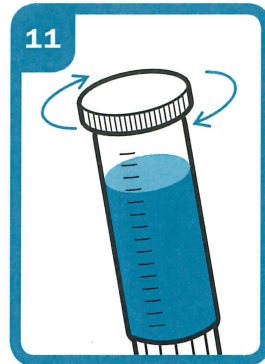

**Twist top tightly to seal.**

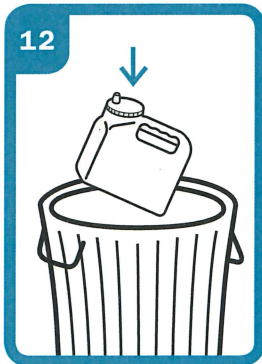

Flush the remaining urine. Do not discard the preservative bottle or cap into the toilet. The jug, preservative bottle and cap can be discarded into the trash.

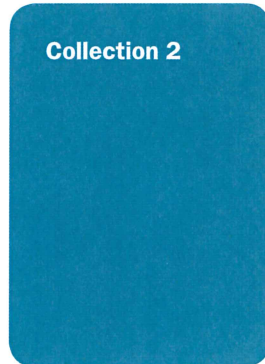

If you have been instructed to complete two 24-hour collections, continue with the instructions for Collection 2, **otherwise skip to the shipping instructions.**

**1**

**Collection 2**

START TIME: \_\_\_\_\_

*EXAMPLE*

**The START TIME of the second collection is the same as the STOP TIME of the first collection.**

Record the START TIME of the second sample on the *Collection Data Form*.

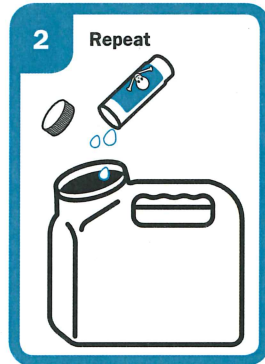

Repeat steps from **Collection 1** starting at number 3.